



The Four Corners Showcase of  
Holistic & Ecological  
Products, Services & Seminars

September 9 & 10, 2023  
La Plata County Fairgrounds  
Main Exhibit Hall  
Durango, Colorado

SPONSORED BY:



259 Crazy Horse Drive  
Durango, CO 81301  
wholeexpodurango@gmail.com  
www.WholeExpo.com

**SHOWCASE YOURSELF AT WHOLEEXPO!**

Hello,

It's time to reserve your booth for the 27th Annual WholeExpo. This is the Four Corners' one and only showcase of holistic and ecological products and services. WholeExpo Durango is your opportunity to connect with all those new prospects and returning customers.

Here's how to get started:

Complete the exhibitor's contract. Please read everything carefully! Call me if you have any questions at (970) 903-2342.

Enclose your payment. In order to qualify for 20% discount, payment in full must be received by April 1. You may split your fee into two payments. If the 2nd payment is not received by April 1, discount is forfeited and you will be charged full price.

If mailing, send your payment and agreement to:

**WholeExpo**  
**259 Crazy Horse Drive**  
**Durango, CO 81301**

If making a payment by credit card, please call me with your card information - do not write your card information on your contract. You may scan (or photograph) and email your agreement to wholeexpodurango@gmail.com.

Please be sure I have your daytime phone number and email. Call me at 970-903-2342 to discuss booth options or for answers to any questions. We are looking forward to having you join us for WholeExpo 2023!

*Sharon Hermes*

Sharon Hermes  
Owner/Producer  
(970) 903-2342  
wholeexpodurango@gmail.com





**The Four Corners Showcase of Holistic & Ecological Products, Services & Seminars**

**Saturday, Sept. 9 and Sunday, Sept. 10, 2023**  
**La Plata County Fairgrounds Main Exhibit Hall • Durango, Colorado**

**CONNECT WITH CONSCIOUSLY AWARE INDIVIDUALS  
WHO WANT YOUR PRODUCTS AND SERVICES!**

### **NOW IN ITS 27th YEAR**

WholeExpo has been a part of the Four Corners community for over 27 years. The Four Corners has proven to be a conscious community with a significant interest in healthy, holistic living and ecological awareness. By offering the opportunity to talk one-on-one to some 70 exhibiting businesses and attend 20+ seminars and events, WholeExpo helps keep the community educated and aware of products and ideas that lead to healthier lifestyles. We believe it is important to educate as many people as possible on alternative, earth-friendly services that are both beneficial and gentle on the body, mind, spirit as well as the environment.

### **BENEFIT FROM WHOLEEXPO**

The Four Corners market has always been home to many thousands of health motivated and environmentally aware people. These are the people who participate in and attend WholeExpo. Our sponsors, advertisers, and vendors are local, regional, and national businesses that support healthy living. Through your involvement with WholeExpo, you will not only receive priceless promotion and goodwill, but you will also begin to be known as a major supporter of healthy, conscious living by your local community.

**Benefit by Being An Exhibitor!** Meet new prospects interested in your products and services • Distribute your literature • Sell directly to the public • Offer product/service samples • Promote your business • Educate and enlighten • Increase your client base • Expand your mailing list • Network with like-minded people.

**WholeExpo Sponsorship Benefits Your Business!** In this day and age, it is a prudent business decision to be viewed as a leader in the community by being associated with large events that promote healthy living and the ecological importance of sustainability. Receive the attention and positive return that being a supporter of this community event brings to your business.

**Program Advertising Benefits!** Advertising in the Expo program is a benefit to any business, whether or not you are exhibiting, because of affordable pricing for a community interested in healthy lifestyles. Advertising in the program is an effective way to reach this specific demographic. Plus, attendees keep the program for future reference and valuable contact information. Having 26+ years knowledge of our clientele, we can help you determine if advertising in the program is right for you.

### **GET DETAILS TODAY AND RESERVE YOUR BOOTH SPACE NOW!**

Call us at (970) 903-2342  
Visit web [www.WholeExpo.com](http://www.WholeExpo.com)  
or write to WholeExpo • 259 Crazy Horse Drive • Durango CO 81301  
or e-mail [wholeexpodurango@gmail.com](mailto:wholeexpodurango@gmail.com)



## The Four Corners Showcase of Holistic & Ecological Products, Services & Seminars

September 9 & 10, 2023

### Exhibitor Space Application/Agreement

Business Name: \_\_\_\_\_ Date: \_\_\_\_\_

Name: \_\_\_\_\_ Phone: \_\_\_\_\_ E-mail: \_\_\_\_\_

Mailing Address \_\_\_\_\_

City: \_\_\_\_\_ State: \_\_\_\_\_ Zip: \_\_\_\_\_

Website: \_\_\_\_\_

#### **Booth Sizes and Prices.**

(PLEASE measure out your space at home before you decide so you know you can fit what you need inside.)

6' wide x 8' deep: \$235.00 • 6' wide x 8' deep corner: \$258.50

6' wide x 10' deep: \$295.00 (no corners)

8' wide x 8' deep: \$300.00 • 8' wide x 8' deep corner: \$330.00

10' wide x 8' deep Angle: \$355.00

8' wide x 10' deep: \$375.00 • 8' wide x 10' deep corner: \$412.50

10' wide x 10' deep: \$450.00 • 10' wide x 10' deep corner: \$495.00

20' wide x 8' deep corner angle: \$700.00

#### **Early-Bird Discount.**

20% off booth price (only) if FULL payment is received by April 1. No discount on tables or pipe & drape.

If full payment is not made by early-bird deadline, the discount will not apply.

#### **Split Payment.**

You may split your payment into two payments. After June 1, there is a \$35 late fee if not paid in full. However, you still must make your payments by the early-bird deadline to receive the early-bird discount.

#### **Booth(s) Requested. Please make 3 selections.**

(WholeExpo reserves the right to adjust the show floorplan if necessary.)

1st choice: \_\_\_\_\_ 2nd \_\_\_\_\_ 3rd: \_\_\_\_\_

Booth Rental Fee: \_\_\_\_\_

8' x 30" table without cover, quantity: \_\_\_\_\_ x 10.00 = \_\_\_\_\_ ( \$20 at show)

6' x 20" table without cover (rented from 3rd party), quantity: \_\_\_\_\_ x 15.00 = \_\_\_\_\_ (must be ordered in advance)

Pipe & Drape Sets (1, 8-ft. back + 2, 3-ft. sides), quantity: \_\_\_\_\_ x 130.00 = \_\_\_\_\_

Electricity, 110v: is included at no charge. Please bring your own extension cord.

Split payment fee of \$35 (if not paid in full by June 1): \_\_\_\_\_

Subtotal: \_\_\_\_\_

Total Due: \_\_\_\_\_

Total included with this agreement: \_\_\_\_\_

Balance due: \_\_\_\_\_

☐ Check enclosed ☐ Charge my credit card. Please call Sharon Hermes, show Producer at 970-903-2342, with your card information. Do not write your information on this form. Note, any balance on a split payment will be automatically charged to this credit card on the final due date unless other arrangements have been made.

**Default:** If payment is not made per this agreement, WholeExpo may cancel this contract and release said space without notice or refund. If payment for verbal or written reserved space is not received within 10 days of the reservation, the space will be released. No exhibitor will be allowed to set up or occupy their space unless payment in full has been received and processed.

**Booth Description:** Provide a 40-word booth description of your booth. Include services you will be providing, major items to be sold or activity to take place in your booth. Include a web address if you would like a link from our web site (a reciprocal link is appreciated). This information is for the program. Remember, many attendees keep their programs so include a contact web site, e-mail and/or phone. Your description may be edited.

If possible, PLEASE E-MAIL YOUR DESCRIPTION. If you are e-mailing your description, it must be received before this agreement can be approved. Indicate if you are. You might wish to include a phone number, e-mail and/or website. **40 WORD MAXIMUM ONLY!**

Booth Title/Name for Program & Web: \_\_\_\_\_

---

---

---

---

---

**Damage:** Exhibitors are liable for any damage caused by their actions to floors, walls, provided booth equipment, etc. Duct tape shall not be used to attach anything to anything not belonging to the Exhibitor.

**Booth Cancellation:** Booth rentals cancelled by June 1 will receive a 50% refund. No refund will be issued for booths cancelled after June 1.

**Booth Set up:** Booth set up is from noon to 6 pm on Friday before the show and (with Producer's approval) 8:00 am to 9:30 am on Saturday morning of the show. All booths must be set up, and exhibitor shall be ready for the doors to open by 9:30 am on Saturday of the show. Any booth unoccupied as of 9:00 am on Saturday of the show will be considered cancelled and may be re-rented by WholeExpo without compensation to Exhibitor.

**Booth Dismantle & Removal:** Booth dismantle is from 5:00 pm to 8:00 pm on Sunday, at show conclusion. **Exhibitors may not begin booth dismantling/packing prior to 5:00 pm on Sunday.** Exhibitor shall remove all of its property by 8:00 pm on Sunday of the show. After this time, WholeExpo has the authority to remove and dispose of Exhibitor's property that is not removed from La Plata County Fairground premises, and Exhibitor agrees to pay the cost incurred by WholeExpo in connection with such removal and disposal.

**Sales tax:** Exhibitors agree to be responsible and to hold WholeExpo harmless for any sales or use taxes imposed by any government agency upon any product or service sales made by the exhibitor.

**Other:** Any matter not specifically covered in this agreement or associated exhibition rules shall be subject solely to the decision of WholeExpo.

**Violation of the Exhibitor rules** shall be cause either for immediate expulsion of Exhibitor without recompense, or rectification by WholeExpo at Exhibitor's expense. WholeExpo reserves the right to refuse/revoke any booth rental application without explanation.

**Applicable Law; Choice of Law; Venue:** Exhibitor shall abide by all applicable federal and state laws and regulations, and all ordinances, rules and regulations of the City of Durango. In any action, suit or legal dispute arising from this Agreement, Exhibitor agrees that the laws of the State of Colorado shall govern. The parties agree that any action or suit arising from this Agreement shall be commenced in a federal or state court of competent jurisdiction in Durango, Colorado, at WholeExpo's discretion. Any action or suit commenced in the courts of the State of Colorado shall be brought in the First Judicial District.

**Amendment:** This Agreement shall not be altered, changed or amended except by an amendment in writing executed by the parties hereto.

**Binding Effect:** This Agreement shall be binding upon and inure to the benefit of the parties hereto and their respective successors and permitted assigns and is specifically enforceable.

**Force Majeure:** WholeExpo shall have no liability to Exhibitor, and Exhibitor shall have no claim or action against WholeExpo therefore, because of WholeExpo's failure to perform any of its obligations in the Agreement if the failure is due to unforeseen occurrences or to reasons beyond WholeExpo's reasonable control, including without limitation, strikes or other labor difficulties, war, riot, terrorism, civil insurrection, accidents, acts of God or governmental authorities in connection with a national, state, or local emergency. In such event, Exhibitor's sole remedy shall be limited to cancellation and WholeExpo may retain such part of each Exhibitor's rental as shall be required to cover expenditures already made up to such occurrence.

I have read the terms and conditions of WholeExpo on both pages of this form as well as the exhibitor rules. I understand and agree to these terms and conditions and understand that they will be enforced. All applications subject to approval.

\_\_\_\_\_  
Signature, Exhibitor

\_\_\_\_\_  
Date

\_\_\_\_\_  
Signature, WholeExpo

\_\_\_\_\_  
Date

Booth(s) assigned: \_\_\_\_\_

Durango LLC  
September 9 & 10, 2023

# The Four Corners Showcase of Holistic & Ecological Products, Services & Seminars

6'w x 8'd

\$235

add 10% for corner  
(see early bird special below)

6'w x 10'd

\$295 (no corners)

(see early bird special below)

8'w x 8'd

\$300

add 10% for corner  
(see early bird special below)

10'w x 8'd Angle

\$355

(see early bird special below)

8'w x 10'd

\$375

add 10% for corner  
(see early bird special below)

10'w x 10'd

\$450

add 10% for corner  
(see early bird special below)

20'w x 8'd L-booth

\$700

(see early bird special below)

## EARLY BIRD SPECIAL

Prior to 4/1 deduct 20%  
of your booth rental fee.

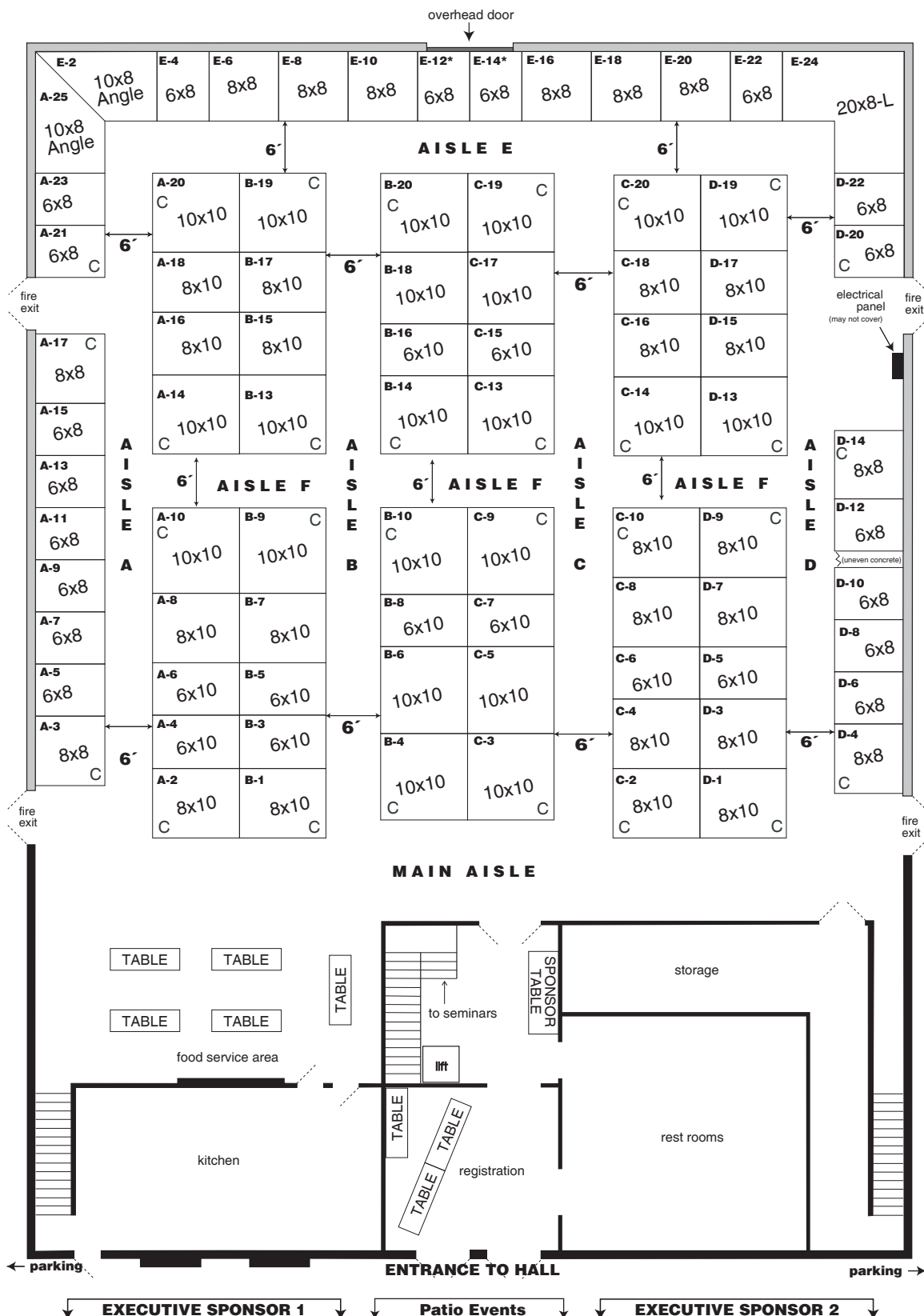

\*These booths are impacted by loading during early setup.

# **WholeExpo Exhibition Rules & Additional Information January 1, 2023**

## **These rules form a part of the contractual agreement with the exhibitor.**

**Free Passes:** Each Exhibitor will receive FREE passes to hand out/mail to customers/clients. This helps promote the show and create goodwill amongst your clients. Your staff do not require a free pass. They identify themselves at the registration table and request a badge.

**Hours of Event/Hall Access:** Show hours are 10:00 am - 5:00 pm Saturday and 10:00 am - 5:00 pm Sunday. Exhibitors with a valid pass may access the hall beginning at 8:00 am Saturday and at 9:00 am Sunday.

**Electricity:** Electricity will be provided to some corner of your booth, but you must provide the extension cord to get to the other corner, if needed. There is no additional charge for electricity.

**Dividers/Pipe & Drape:** WholeExpo rents pipe & drape from a third party. Please order in advance. Exhibitors requiring dividers between their adjoining booths may supply their own. Any divider must not show an ugly surface to neighboring booths, either to the side or the back. Since booths do not have a back wall to hang a sign from, be creative.

**Booth Properties:** No materials that would impede the flow of water from the sprinkler system are allowed to cover the top framework of booths. This includes water proof canopies, shade covers, canvas, etc. Unfortunately, this means no tents.

**Decorations:** Decorations used by Exhibitors must be of flameproof and/or fire resistant material. Exhibitor shall not use glitter, confetti, hay or straw in any form. Stick-on decals or similar adhesive backed promotional items may not be distributed or used on La Plata County Fairgrounds.

**Passageways:** Exhibitor shall not obstruct any portion of the aisles, corridors, vestibules, lobbies, fire hose, cabinets, or access to utilities at La Plata County Fairgrounds. All tables, chairs, displays, etc must remain within the Exhibitor's booth area. The Fire Department will inspect to ensure compliance.

**Clean-up:** At move-in and move-out, exhibitor agrees to clean up and deposit in waste-baskets all trash including, but not limited to boxes, paper, plastic wrap and styrofoam peanuts so that the area may be vacuumed. Exhibitor agrees to pay a \$35.00 cleaning fee if their booth is left with trash.

**Hazardous Materials:** Exhibitor shall not bring any flammable liquids, gasoline, fuels, oils, machinery, or smoking materials onto La Plata County Fairgrounds premises without the prior written consent of WholeExpo. No open flames, lighted candles or lighted incense/sage sticks are permitted.

**Parking:** All Exhibitors may park near the loading areas during set up hours only. On Saturday and Sunday, exhibitors and their staff must park in the parking lot on the south side of the building by the high school. This lot is accessed at the light at 24th street. The gate will be open on the weekend.

**Animals:** Exhibitor shall not allow any animals on La Plata County Fairgrounds premises without the prior written consent of WholeExpo.

**Security and Insurance:** There is no special on-site security, so valuable items should be secured. WholeExpo LLC, show sponsors and La Plata County Fairgrounds are not liable for theft or damage to exhibitor products or materials. Fire and theft insurance, if desired, must be acquired by the exhibitor at exhibitor's expense. Exhibitor shall be responsible for insuring any property brought on La Plata County Fairgrounds premises. WholeExpo shall not be required to furnish content insurance for Exhibitor's property, or for any other person brought on La Plata County Fairground premises in conjunction with WholeExpo.

**Concessionaire:** Sales of prepared foods and drinks are permitted only by the food service vendor and must be within the food service area. Food service vendor agrees to leave the kitchen area, floors, fixtures and equipment/appliances clean per Fairgrounds requirements.

**Smoking Restrictions:** In compliance with City of Durango policy, smoking is prohibited in all areas of La Plata County Fairground premises.

**Booth Staffing:** Booths should be staffed at all times during the show hours.

**Booth Tear-down:** Booth tear-down shall not begin prior to 5:00 pm on Sunday.

**Booth Flooring:** Carpet is not available through WholeExpo. Exhibitors desiring carpet must provide their own.

**Activities:** No illegal activities may take place in any booth. All activities, including literature distribution, must occur within the Exhibitor's booth area.

**Sound Equipment:** Sound equipment may not project sound beyond the confines of the booth area. Provide headphones as appropriate.

**Exhibitor Badges:** Exhibitor badges will be provided for each exhibitor and their staff. These badges are your pass into the exhibit area, and must be displayed to gain access. If a badge is lost, a new one will be provided at the registration desk.



# Increase Your Exposure! • Improve Your Show Results!

Market yourself with a display ad in the official WholeExpo show program!

**wholeexpo** LLC  
27th Annual Durango 2023



26th Annual  
DURANGO 2022

*The Four Corners  
Showcase of Holistic &  
Ecological Products,  
Seminars and Services*

**Connect with Other Consciously Aware Individuals,  
Enjoy a Variety of More Than 50 Exhibitors,  
20 Seminars/Workshops, Music, Food and More!**

WEEKEND AFTER LABOR DAY  
SATURDAY, SEPT. 10 10:00 AM-5:00 PM SUNDAY, SEPT. 11 10:00-5:00 PM

LA PLATA COUNTY FAIRGROUNDS  
MAIN EXHIBIT HALL  
2500 N. MAIN AVE  
DURANGO, COLORADO

Exhibitor List, Speaker Schedule &  
Event Info at [WholeExpo.com](http://WholeExpo.com)  
[Facebook.com/WholeExpo](https://Facebook.com/WholeExpo)

Admission \$5 Adults, Children 12 & under Free

Sponsored by:



The Four Corners Showcase of Holistic & Ecological Products, Services & Seminars

## Workshops

In an Army clinic, she set  
arn the art of mastering  
rough cognitive behavioral  
Her newfound passion for  
sulted in the creation of a  
she called Sleep Gym,  
then later shared with  
VA and DoD providers.  
on the program's success,  
s invited and sat on the  
nical Recommendations  
p Post-Concussion work  
Laura continues to learn  
deep mastery and finds  
ple activity to be highly  
t and attainable.

5:00  
**A Hopi Shaman's  
Wisdom: The  
4 Virtues to  
Enlightenment with  
De Alva Ward**

ople are known as  
aceful People". Their  
stem is based on the  
and sacredness of

universal connection. Sacredness  
evolves from the four virtues of  
universal laws. Understanding  
this connection opens the  
gateway to understanding your  
connection with the world and your  
environment. By implementing  
these virtues you will attain a  
deeper meaning to life, bringing  
you closer to a higher power  
and gaining wisdom to your own  
enlightenment.

De Alva Ward is a Hopi Shaman,  
spiritual teacher, and speaker.  
She incorporates her techniques  
based on her cultural and spiritual  
wisdom into her healing sessions  
and readings to bring harmony  
to the mind, body, and spirit.  
Her lectures are about Native  
American wisdom that can bring  
balance to a modern lifestyle and  
empower individuality for a deeper  
spiritual path to life.



*live a healthy life for  
your kids*

**NATURE'S  
OASIS**

locally grown  
FAMILY OWNED  
EST. 1993

970.247.1988  
300 S. Camino del Rio | Durango  
[NaturesOasisMarket.com](http://NaturesOasisMarket.com)

your Divine Calling;  
site that generates real  
a traffic and reach a

igh seminar leader  
on coach. He currently  
internet businesses that  
automatic income. He  
-Behavioral Psychology,  
Counseling and a PhD.  
Psychology.

## Counseling

Coaching • Counseling  
communication  
ship • Career  
Business  
3764  
6-0403  
[sultgalaya.com](mailto:sultgalaya.com)

**DOWNTOWN**

**Act  
Today!**

**Affordable Prices!  
Space Is Limited!**

*See reverse for prices & size*

3:00 - 4:00

**Self-Healing  
Immersion  
with Shannon Van  
Den Berg**

Self-healing is the key to all transforma-  
tion. It raises your vibration, shifts your  
consciousness, manifests your desires,  
and accelerates spiritual growth. Knowing  
how to start your self-healing path and  
cultivate an aligned daily practice creates  
a foundation for deep, powerful life trans-  
formation and multidimensional connec-  
tions. Whether you want to deepen your  
spirituality, open to the flow of prosperity,  
heal your body or change the vibration of  
the planet, self-healing lays the foundation  
for all growth and expansion. Shannon will  
give you tools to step firmly into your self-  
healing path and will facilitate a shamanic

## SHARE YOUR THOUGHTS, VISION AND VOICE!

Write on topics like: Health & Wellness, Local Business,  
Food, Lifestyle, Events & more...

**DURANGO  
DOWNTOWN.com**

**BLOGGERS  
WANTED**

for details visit  
[durangodowntown.com/contributors](http://durangodowntown.com/contributors)

# Increase Your Exposure! Advertise In The WholeExpo 2023 Durango Program.

1/12 Page: 2 1/4" (W) x 2 1/8" (H)

Exhibitors: \$54 B & W

Non-Exhibitors: \$97 B & W

(color not available)

1/6 Page: 4 3/4" (W) x 2 1/8" (H)

Exhibitors: \$97 B & W

Non-Exhibitors: \$174 B & W

(color not available)

**Thousands of programs  
are distributed and read  
before, during & after the  
show. Take advantage of  
this cost-effective  
opportunity!**



1/3 Page Square: 4 3/4" (W) x 4 3/8" (H)

1/3 Page Vert.: 2 1/4" (W) x 9 1/4" (H)

Exhibitors: \$175 B & W

Non-Exhibitors: \$313 B & W

(color not available)

1/6 Page: 2 1/4" (W) x 4 3/8" (H)

Exhibitors: \$97 B & W

Non-Exhibitors: \$174 B & W

(color not available)

1/2 page: 7 1/4" (W) x 4 3/8" (H)

Exhibitors: \$234 B & W, \$384 Full Color

Non-Exhibitors: \$421 B & W, \$690 Full Color

1/2 Page Full Color is back cover only—only 1 available.

Full page: 7 1/4" (W) x 9 1/4" (H)

Exhibitors: \$421 B & W, \$690 Full Color

Non-Exhibitors: \$758 B & W, \$1,243 Full Color

Full Page Color is inside only.

**Increase Traffic To Your Booth! Call 970-903-2342 To Reserve Your Ad Today!  
Ad deadline: Space Reservation with payment 6/15. Finished ads due 6/30.**

Organization Name: \_\_\_\_\_ Date: \_\_\_\_\_

Contact Person: \_\_\_\_\_ Phone: \_\_\_\_\_ Email: \_\_\_\_\_

Address: \_\_\_\_\_ City: \_\_\_\_\_ State: \_\_\_\_\_ Zip: \_\_\_\_\_

☐ I want you to build my ad, please call.<sup>1</sup>

☐ My ad is enclosed as a digital file.<sup>2</sup>

☐ Reserve my space. My ad will be forwarded to you.

Size of Exhibitor ad purchased: ☐ 1/12 pg (\$54) ☐ 1/6 pg horiz. (\$97) ☐ 1/6 pg vert. (\$97) ☐ 1/3 pg square (\$175) ☐ 1/3 pg vert. (\$175)

☐ 1/2 pg b&w (\$234) ☐ 1/2 pg color (\$384) ☐ full pg b&w (\$421) ☐ full pg color (\$690)

Non-exhibitor Ad purchased: ☐ 1/12 pg (\$97) ☐ 1/6 pg horiz. (\$174) ☐ 1/6 pg vert. (\$174) ☐ 1/3 pg square (\$313) ☐ 1/3 pg vert. (\$313)

☐ 1/2 pg b&w (\$421) ☐ 1/2 pg color (\$690) ☐ full pg b&w (\$758) ☐ full pg color (\$1,243)

☐ Check enclosed

☐ Charge my credit card. Please call Sharon Hermes, show producer, at 970-903-2342 with your card information.

Signature: \_\_\_\_\_

<sup>1</sup>Design costs are a \$50 minimum and are billed at \$96 per hour. Provide us with a rough idea of how you wish your ad to look, and we will provide you with an estimate.

<sup>2</sup>Provided ads must be as electronic files in EPS, Tiff or PDF formats ONLY as grayscale (or CMYK if full color) with a border. NO MS WORD FILES. All image files must be a minimum of 300 dpi at proper size. All fonts must be rasterized, converted to outlines or embedded. Please call our design department at (970) 903-2342 with questions or for additional details on electronic file requirements.



# **Call for Speakers**

## **Present a Seminar or Workshop at WholeExpo**

### **Speaker submission deadline is May 15**

Offering a seminar or workshop at WholeExpo allows you to educate interested individuals in a subject area in which you are knowledgeable and enjoy. This offers great personal satisfaction while allowing attendees to become aware of your expertise. WholeExpo presenters are not paid and offer their time as a service to the community.

Approximately 14 seminars and workshops are provided over the two days of WholeExpo, each 1 hour long. Presentation times are scheduled over the two day period of the show solely at the discretion of WholeExpo. Presenters are selected by our Educational Advisory Committee, a volunteer group of dedicated and knowledgeable individuals. Decisions on speakers are based on reputation, publications, and materials submitted to the committee, as well as offering a diverse program to the attendees.

**PLEASE NOTE:** Presenters are prohibited from offering a sales or promotional presentation. The presentation should offer value to the attendees without the necessity of purchasing any item.

A white board and flip chart are available. We do not have an overhead or LCD projector but do provide a screen. A projector may be rented from La Plata County Fairgrounds office, 970-382-6467.

In order to be considered for a presenter's position, it is very important to submit the following information utilizing the word maximums outlined below. The preferred method for our committee to receive this is via e-mail. If you do not have access to e-mail, please send via mail the following information legibly written or typed.

1. Name
2. Phone
3. Cell Phone
4. e-mail
5. Organization (if applicable)
6. Mailing Address
7. Presentation Title
8. Summary of Presentation - will be used in program (100 word max).
9. Brief Bio - will be used in program (75 word max).
10. Photo: jpeg or tif of photo at 200+ ppi resolution at approx. 2" size head shot.

The summary information is brief, so please include additional information on your presentation and self that you feel would be beneficial to the Educational Advisory Committee in their selection process.

E-mail your information to: [wholeexpodurango@gmail.com](mailto:wholeexpodurango@gmail.com).

If you have questions, please feel free to give us a call at (970) 903-2342.

## **Entertain or Offer a Demonstration at WholeExpo**

### **Submission Deadline is May 15**

In 2011 WholeExpo introduced outdoor entertainment and demonstrations. Since then, attendees have enjoyed flute music, crystal bowl healing, drumming circles, tuning fork healing demonstrations, rock readings, past life regressions, perfume making, messages from the other side, Zumba dance, Qigong, Oneness Blessings, and belly dancing, to name a few. We don't mind repeats.

If you have something that would fit into this category that you would like to share with attendees, please submit the information listed below and send it to WholeExpo.

The time frame for this is a 25–45 minute spot as planned in advance. These spots are NOT to be used for selling products. That must take place in exhibitors' booths only.

Presentation times are scheduled over the two-day period of the show solely at the discretion of WholeExpo.

These entertainment / demonstrations are held under cover outside on the patio. Rain is not a problem, though we cannot control wind. Electricity is available.

To be considered, it is very important to submit the following materials:

1. Name
2. Phone
3. Cell
4. e-mail
5. Organization (if applicable)
6. Mailing Address
7. Event Title
8. Summary of Event - will be used in program (25 word max).

The summary information is brief, so please include additional information on your presentation and self that you feel would be beneficial to us in our selection process.

E-mail your information to: [wholeexpodurango@gmail.com](mailto:wholeexpodurango@gmail.com).

If you have questions, please feel free to give us a call at (970) 903-2342.